



Smart Valve Positioner TS900 Series

- Quick and easy auto calibration
- Flapper / Nozzle type Torque motor
- By-pass valve (A/M switch) installed
- PST & Alarm & Diagnostic function
- Advanced diagnostics

Smart Valve Positioner TS900/TS905 Series (Flame proof type)

Description

TS900 Smart Valve Positioner controls the valve stroke in response to an input signal of 4-20mA from the control panel, DCS, or calibrator.

Certified



Features



TS900



TS905

- + Quick and easy auto calibration
- + Large flow pilot valve (Over than 100LPM)
- + Flapper / Nozzle type Torque motor
- + By-pass valve (A/M switch) installed
- + HART communication (HART 7)
- + Partial stroke test (PST) function
- + Alarm function (Option)
- + Advanced diagnostics (Option)

Structure

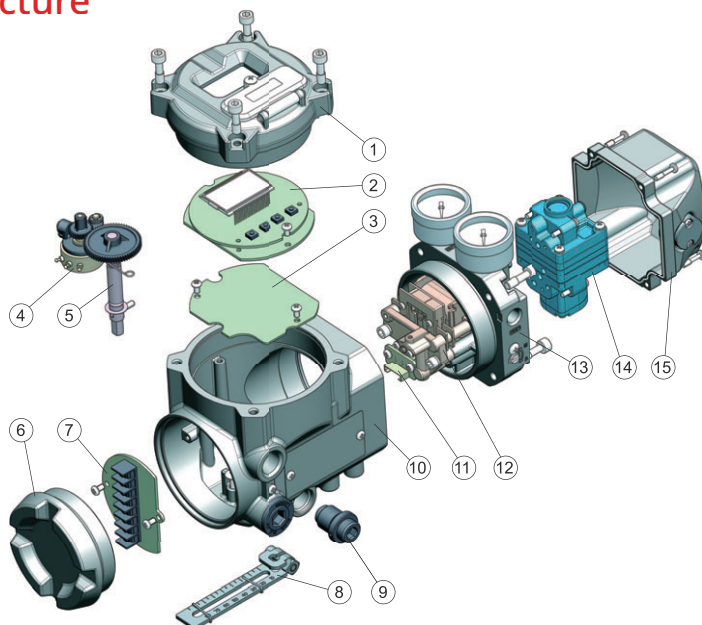

1. Body cover
2. Main PCB
3. PCB guide
4. Potentiometer
5. Main shaft
6. Junction box cover
7. Terminal PCB
8. Feedback lever
9. Plug drain
10. Base body
11. Pressure sensor (Option)
12. Torque motor
13. Air connection block
14. Pilot valve
15. Pilot valve cover

Smart Valve Positioner TS900/TS905 Series (Flame proof type)

Specifications

Model	TS900	TS905
Input signal	4~20mA DC	
Impedance	500Ω at 20mA DC	
Supply pressure	0.14~0.7MPa	
Stroke	10~150mm(Linear), 0~90°(Rotary)	
Air connection	NPT1/4, G1/4	
Gauge connection	NPT1/8	
Conduit	NPT1/2, M20	
Explosion proof type	II 2G Ex db IIC T5/T6 Gb II 2D Ex tb IIIC T85°C/T100 °C Db	
Enclosure	IP66 (EN60529)	
Ambient Temp.	Standard type	-30°C~80°C
	Low temp type	-40°C~80°C
	Explosion proof	-40°C~80°C(T5) / -40°C~70°C(T6)
	LCD operating	-30°C~85°C
Linearity	±0.5% F.S.	
Sensitivity	±0.2% F.S.	
Hysteresis	±0.5% F.S.	
Repeatability	±0.3% F.S.	
Air consumption	Below 2.3LPM (Sup=0.14MPa)	
Required air quality	Class 3 (ISO 8573-1)	
Flow capacity	Over 100LPM (Sup=0.14MPa)	
Material	Aluminum die cast	Stainless Steel 316
Weight	3.5kg	7.0kg
HART version*	HART 7	
Position transmitter*	Connection type	2 Wire
	Supply voltage	9~30V DC
Alarm switch*	9~30V DC	

* Options

Dimension [Unit:mm]

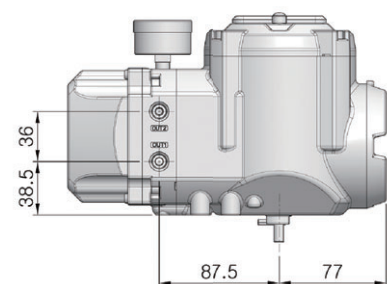
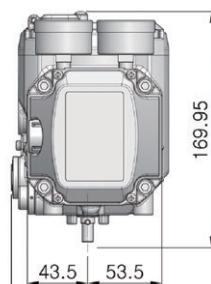
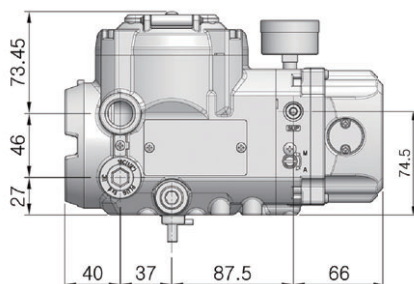
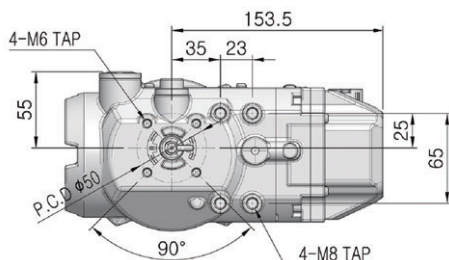

Product code

Model	TS9								
Option	Standard type	0							
	Natural gas type*	9							
Body material	Aluminum	0							
	Stainless steel 316	5							
Acting type	Linear (Potentiometer type)	L							
	Rotary (Potentiometer type)	R							
	Linear (Non-Contact Sensor)	S							
	Rotary (Non-Contact Sensor)	Q							
Explosion proof type	ATEX & IECEx						A		
	KCS						K		
	CCC, EAC						C		
	CSA/US						S		
Connection type	Conduit entry		Air connection						
	NPT1/2		NPT1/4				3		
	M20		NPT1/4				4		
	M20		G1/4				5		
Lever (Linear type)	10 ~ 70mm							1	
	70 ~ 150mm							2	
	For tubeless actuator (30mm)							3	
	For tubeless actuator (70mm)							4	
Lever (Rotary type)	M6 x 39L							1	
	NAMUR							5	
Ambient Temp.	-30°C~80°C								S
	-40°C~80°C								L
	-60°C~80°C (For EAC)								U
Communication	None								0
	Position transmitter(4~20mA)								1
	HART communication								2
	HART with Position transmitter(4~20mA)								3
	HART with Advanced diagnostics								4
HART with Advanced diagnostics and Position transmitter(4~20mA)								5	
Alarm switch	None								0
	Included								A

* Natural gas type is only available with CSA and EAC.

tissin

Solutions for control valve system

tissin

Tissin Co.,Ltd. (주)티씬

201-1105, No 397, Seokchen-ro, Ojeong-gu,
Bucheon-si, Gyeonggi-do, Korea 14449

Tel : +82-32-624-4573, Fax : +82-32-624-4574

www.tissin.co.kr



Version: PC-900EN_04/2024

We reserve the right to make technical changes or modify
the contents of this document without prior notice.

Copyright © 2024 Tissin
All rights reserved.

Printed in Korea